



REQUEST FOR DIRECTION

Meeting: August 11, 2025

MD OF WILLOW CREEK No. 26- Land Use Bylaw

The MD of Willow Creek No. 26 have completed an update to their land use bylaw. They have circulated for comments. Both the planner from ORRSC and the Development Department will review prior to their deadline of September 5th for any comments, but we wanted to also circulate Council for any comments, questions, feedback prior to submission. The links below provide information in regards to the bylaw.

The Public hearing is scheduled for September 10, 2025, at 1:30 p.m. and any comments should be received by 4:00 p.m. Friday September 5, 2025.

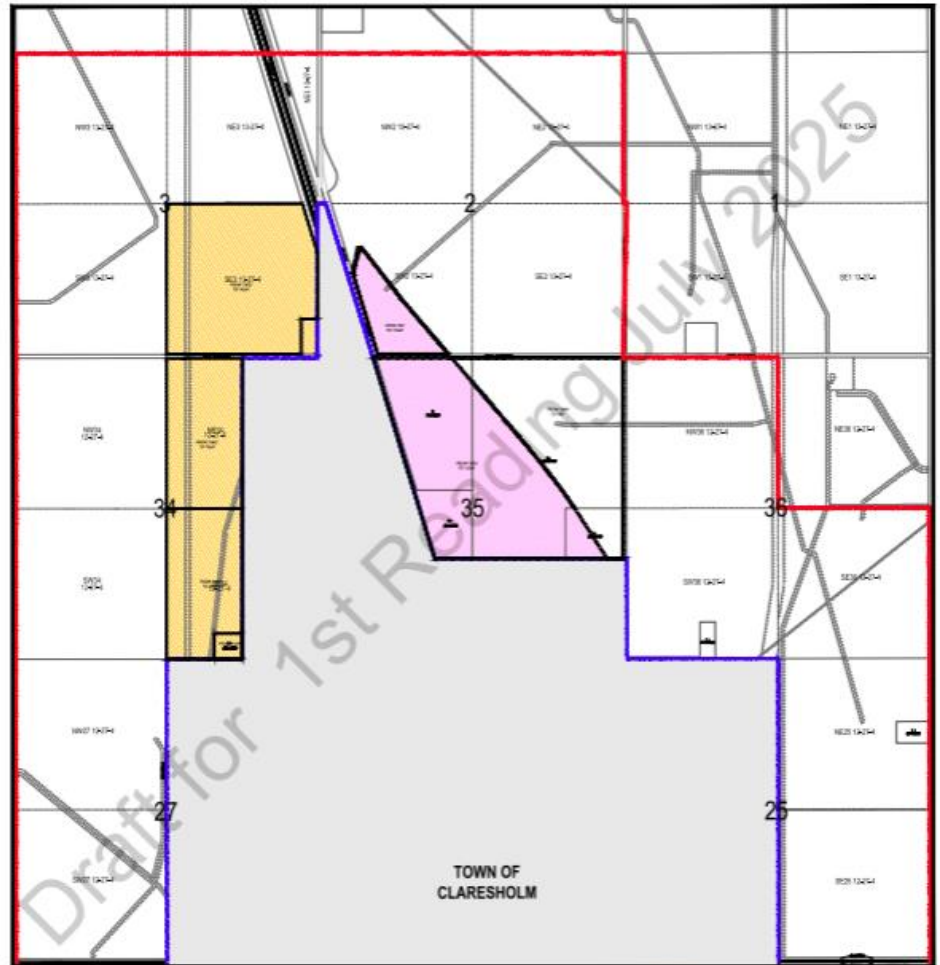

Rural General - (RG)	Rural Recreational - (RR)	Reservoir Vicinity Overlay (RVO)
Hamlet Residential - (HR)	Open Space and Public Recreation - (OPR)	Flood Hazard Protection Overlay (FHPO)
Hamlet Business - (HB)	Public Service - (PS)	Urban Boundary
Willow Creek Business Park - (WCBP)	Nanton Urban Fringe - (NUF)	Urban IDP Boundary
Rural Commercial - (RC)	Residential Growth Area - (RGA)	Division Boundary
Rural Industrial - (RI)	Commercial Industrial Growth Area - (CIGA)	Water Body
Natural Resource Extraction - (NRE)	Use Specific Direct Control - (DC)	
Claresholm Airport - (CA)	Industrial Renewable Energy Direct Control - (IREDC)	

Draft Bylaw:

<https://whatshappening.mdwillowcreek.com/uncategorized/summary-of-changes-to-land-use-bylaw-final-draft-july-2025/>

Public Hearing information:

<https://whatshappening.mdwillowcreek.com/uncategorized/land-use-bylaw-public-hearing-sept-10/>

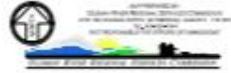

SCHEDULE 1 - DIVISION 4

MD OF WILLOW CREEK NO. 26

LAND USE BYLAW No. _____; DATE: _____

IDP - TOWN OF CLARESHOLM - MAP B

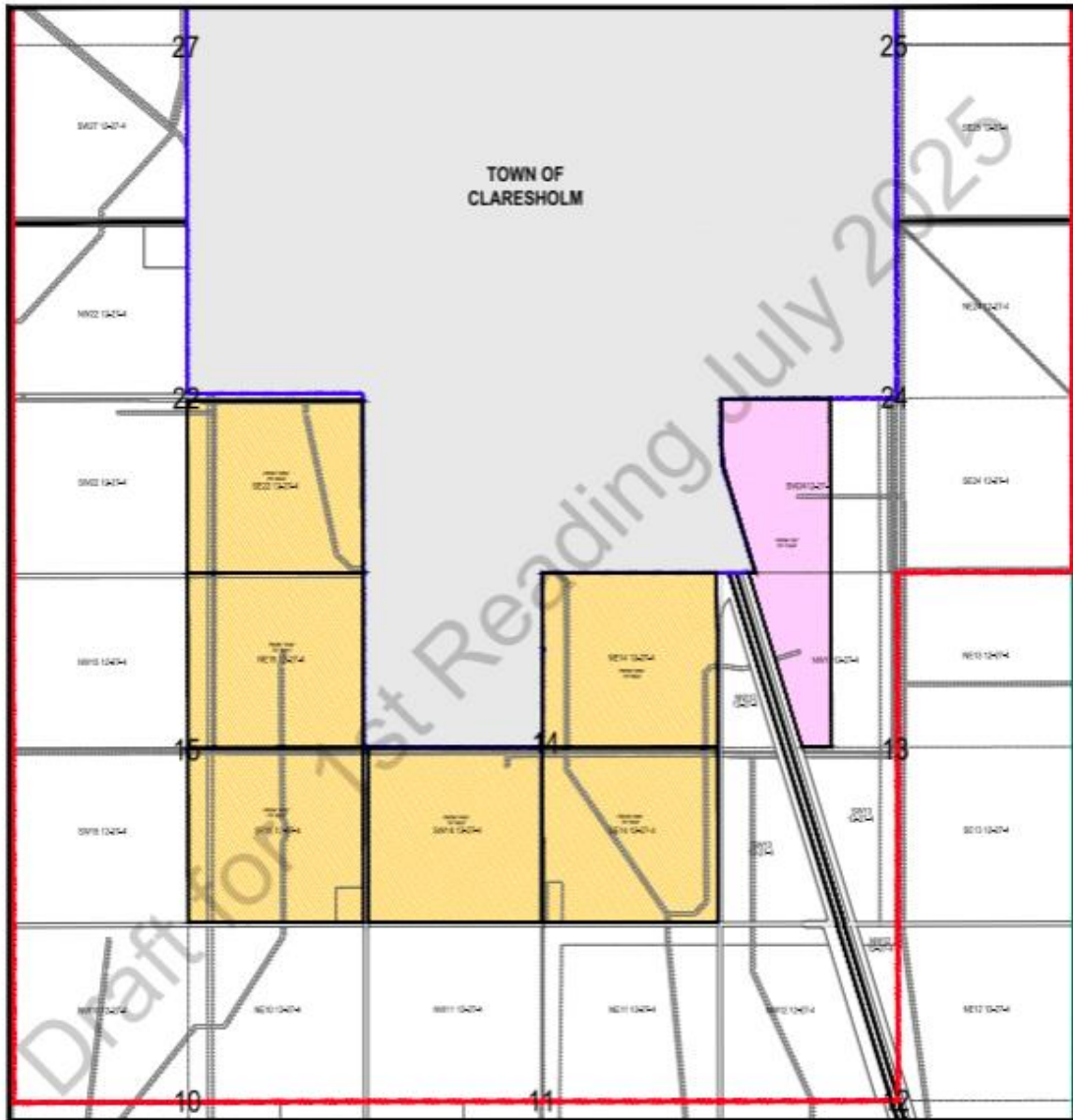

Rural General - (RG)	Rural Recreational - (RR)	Reservoir Vicinity Overlay (RVO)
Hamlet Residential - (HR)	Open Space and Public Recreation - (OPR)	Flood Hazard Protection Overlay (FHPO)
Hamlet Business - (HB)	Public Service - (PS)	Urban Boundary
Willow Creek Business Park - (WCBP)	Nanton Urban Fringe - (NUF)	Urban IDP Boundary
Rural Commercial - (RC)	Residential Growth Area - (RGA)	Division Boundary
Rural Industrial - (RI)	Commercial/Industrial Growth Area - (CIGA)	Water Body
Natural Resource Extraction - (NRE)	Use Specific Direct Control - (DC)	
Claresholm Airport - (CA)	Industrial Renewable Energy Direct Control - (IREDC)	

ATTACHMENTS:

1.) N/A

PREPARED BY: Tara Vandervalk, Development Services Manager

APPROVED BY: Abe Tinney, CAO

DATE: August 5, 2025